



# SHARK

## 281 NC 5.0

Shark 281 NC 5.0, electrohydraulic automatic band sawing machine which can operate also in semi-automatic, semi-automatic/dynamic and manual mode to cut from 0° to 60° left.

- CNC machine with a new controller : MEP 50 with Windows "CE" based. This new PLC has been specifically designed by MEP for the automation of its range of products.

### A FEW FEATURES:

-7" touch screen display operator interface and push buttons for all functions of the sawing machine. It is simple and intuitive , it guarantees a reliable use and it controls all cutting parameters in real time.



OPTIONALS FROM PAG 61 - N° 02 - 03 - 04 - 10 - 17 - 33 - 34 - 49 - 60 - 72

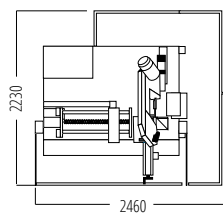
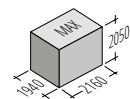

mm	kW	m/min	mm	0°	45°	60°	kg
				250	190	120	
2950x27x0,9	2,2	15÷100	285	230	180	110x110	965



- Console with all centralized controls, installed on an articulated arm to follow the operator in every operating position for the controls and the EMERGENCY.
- Visualization and registration of alarms and events with the possibility to visualize the story of occurred events.
- Electronic inverter for the continuous adjustment of the band speed from 15 to 100 m/min.
- Latest generation hydraulic control unit, with high efficiency and low energy consumption.
- Bar feeder with recirculating balls screw/nut and stepper motor (feed in length in one stroke 600 mm, that can be repeated in order to cut any length).
- Cutting head and feeding vice positioning with joystick
- Automatic acquisition of the actual starting point of the cut.
- Electronic transducer to visualize band tensioning.
- Automatic adaptive shearing stress control system with servovalve mounted directly on the cylinder.



- Coolant tank inside the steel base with two electric pumps so as to lubro-refrigerate band. The drawer to collect chips can be replaced with a motorized chip evacuator (see optionals).
- Preset to be equipped with the spray mist system (OPTIONAL), as well as with the standard-delivered traditional lubrication with emulsible oil.
- Wire chip brush for band cleaning.
- Machine arranged for handling with movement equipment.
- Bi-metal band for solids and sections.
- Service keys and instructions manual for maintenance and spare parts list.

